

HUNTSMAN

BUILDING SOLUTIONS

Enhance Your
Profits With
Spray Foam Solutions



Agricultural Applications

Closed-Cell Spray Foam Insulation

YOU WORK HARD TO NURTURE YOUR INVESTMENT WHETHER IT IS CROPS, POULTRY, LIVESTOCK, OR STORAGE. USE HIGH QUALITY BUILDING MATERIALS TO PROTECT YOUR PROFITS BY CONTROLLING ELEMENTS SUCH AS

- Climate
- Moisture
- Air Quality
- Rodent and Pest Operating/Maintenance Cost



WHICH PRODUCT SHOULD I USE?

In conditioned spaces like crop storage facilities and grow houses, the building code may require a thermal barrier over spray foam insulation. In situations where a thermal barrier is required, we recommend one of our intumescent coating be applied over our closed-cell spray foam products.

In some conditioned and unconditioned spaces, like poultry houses and dairy barns, agricultural exemptions may apply to the structure and a thermal barrier may not be required. When agricultural exemptions apply, we recommend our series of generic closed cell spray foam.

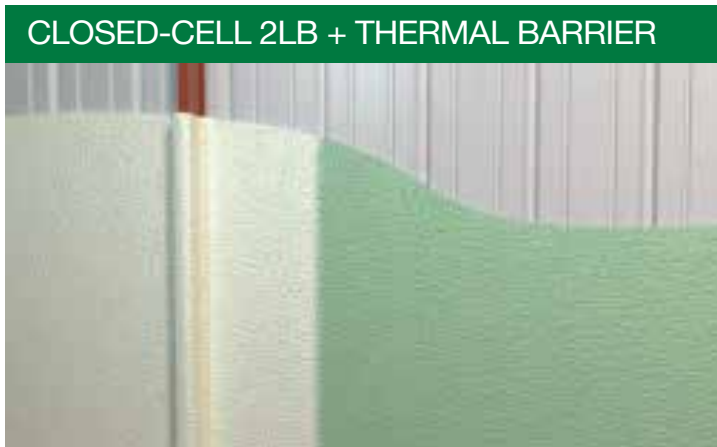

CROP STORAGE & GROW HOUSES

Crop storage facilities and grow houses typically require a controlled environment. Using spray foam insulation will provide an air barrier while allowing you to control temperature and moisture, as well as general air quality. Check with your local code official to see if your building is eligible for agricultural exemptions.





POULTRY HOUSES & DAIRY FARMS

Poultry houses and dairy farms are traditionally non-conditioned spaces, but still require a semi-controlled environment. Using closed-cell spray foam can help control air flow while also making the structure more durable.

Many poultry houses and agricultural buildings may benefit from a strong, durable material along the bottom of the walls to minimize damage done by the chickens or other animals. In these cases, we recommend spraying the lower 2 to 3 feet of the walls with our high density closed-cell (10lb) spray foam, and spraying closed-cell medium density (2lb) spray foam, over the remainder of the wall.

Another effective application option is spraying medium density closed-cell over the entire wall, and then coating the lower 2 to 3 feet of the wall with one of our Coatlok polyurea coatings. Our series of Coatlok coatings are strong enough to protect the foam insulation from chickens and livestock, and can also be used to create a washable surface when sprayed over the entire wall.

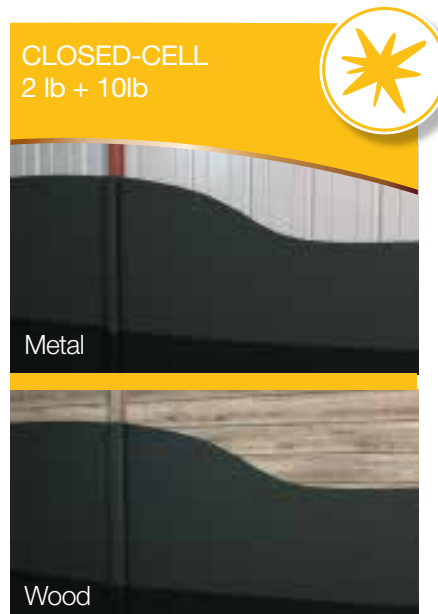
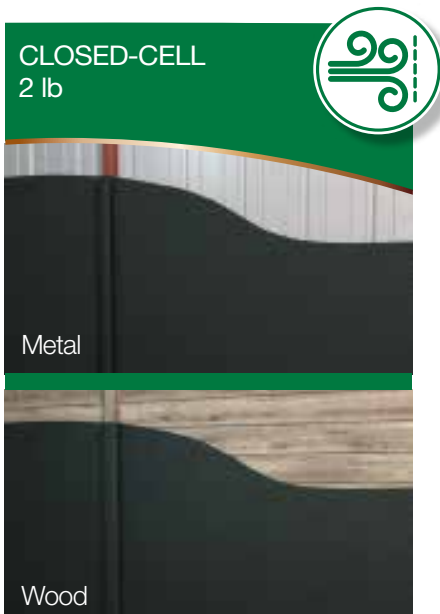

HBS CLOSED-CELL PRODUCTS

HEATLOK HFO HIGH LIFT

Heatlok HFO High Lift is HBS's first product to leverage Honeywell's Solstice® Liquid Blowing Agent technology, which has a GWP of 1, 99.9% lower than traditional blowing agents. Heatlok HFO High Lift combines an R-value of 7.5 with a 6.5" lift to achieve an R-49 in a single pass.

HEATLOK XT

Heatlok XT is a closed-cell spray foam insulation for commercial and residential construction that creates a specially engineered building envelope that provides better thermal resistance, an excellent air barrier, and a recognized vapor retarder. Heatlok XT incorporates more than 20% recycled plastic and renewable oils to create an easier to spray, high yield product.

GENERIC-CLOSED CELL

Generic closed-cell spray foam insulation is for use in agricultural applications. Two variations, high-density and medium-density, are available depending on your specific needs. Both formulas were developed for use in agricultural applications where high performance is required at a lower cost than traditional spray foam. Both formulas provide an air-tight seal, improving performance in barns and other agricultural structures.



COATLOK SERIES

The strength of Huntsman Building Solutions' Coatlok elastomeric polyurea coatings series is versatility. The quick-setting, non-toxic coatings can be applied on numerous substrates including wood, metal, concrete, glass, fiberglass, PVC, and geotextile. Coatlok coatings are UV-stable and chemical-resistant and can be applied on virtually any contour to provide a monolithic barrier.

Ask your General Contractor when renovating or doing new construction how spray foam can work for you. Our Building Science team is standing by to discuss the building envelope design of your next project.